

FORM B – BUILDING

Assessor's Number USGS Quad Area(s) Form Number
Assessor's Number USGS Quad Area(s) Form Number

MASSACHUSETTS HISTORICAL COMMISSION
MASSACHUSETTS ARCHIVES BUILDING
220 MORRISSEY BOULEVARD
BOSTON, MASSACHUSETTS 02125

164; 11C-74	Mt. Toby	E	AMH.160
-------------	----------	---	---------

Photograph



Town/City: Amherst

Place: (*neighborhood or village*):
Lincoln-Sunset National Register District

Address: 160 Lincoln Avenue

Historic Name: Frank C. Sherwin House

Uses: Present: Single-Family Residence

Original: Single-Family Residence

Date of Construction: 1904

Source: deed, tax records

Style/Form: Colonial Revival

Architect/Builder:

Exterior Material:

Foundation: Brick

Wall/Trim: Wood Clapboard; Wood

Roof: Slate

Outbuildings/Secondary Structures:

Major Alterations (*with dates*):

Condition: Good

Moved: no yes **Date:**

Acreage: .46 acre

Setting: Residential street comprising mostly homes built between 1875 and 1920.

Locus Map

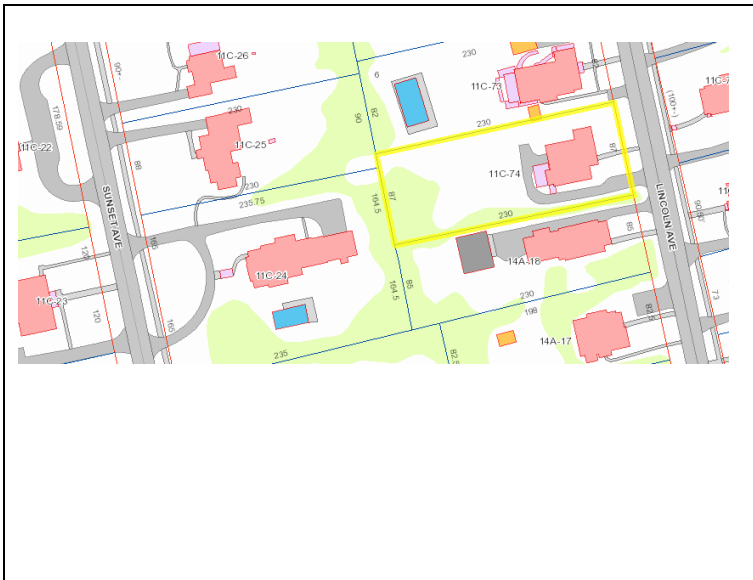

Recorded by: Steve Bloom/Suzannah Fabing

Organization: LHDSC

Date (*month / year*): September 2015

INVENTORY FORM B CONTINUATION SHEET

AMHERST

160 Lincoln Avenue

MASSACHUSETTS HISTORICAL COMMISSION

Area(s) Form No.

220 Morrissey Boulevard, Boston, Massachusetts 02125

E

AMH.160

Recommended for listing in the National Register of Historic Places.

If checked, you must attach a completed National Register Criteria Statement form.

Use as much space as necessary to complete the following entries, allowing text to flow onto additional continuation sheets.

ARCHITECTURAL DESCRIPTION:

Describe architectural features. Evaluate the characteristics of this building in terms of other buildings within the community.

This center-gable Colonial Revival house is related to about 15 houses in the Lincoln-Amity area. Elements common to all are large scale, sidelights and free use of colonial details. This example features small-paned upper double-hung windows on a symmetrical façade. The well detailed doorway and asymmetrical porch are similar to 199 Lincoln. The house features a brick foundation, hipped roof with central front and side gables, and center entry. The entrance is flanked by delicate fluted pilasters and half-length sidelights enclosed in a simple surround. The three-bay façade features symmetrical fenestration with 18/1 double-hung windows and a 12/1 window above the entrance. A first-floor bay projects onto the front porch. This wraparound porch has standard "Tuscan" columns.

****SELECTED TO NATIONAL REGISTER DISTRICT (2/22/1993)****

HISTORICAL NARRATIVE

Discuss the history of the building. Explain its associations with local (or state) history. Include uses of the building, and the role(s) the owners/occupants played within the community.

This house was built in 1904 by Frank C. Sherwin (1860-1908) and his wife Harriet (née Rand). He was an employee of the First National Bank. They are documented at this address in City Directories of 1903-1908. Following his death, the house was acquired by James F. Page, a shoe dealer, and his wife Adeline. They continued to live there at least through 1948.

Lincoln Avenue had been divided into building lots by 1873. They were owned and sold by Stockbridge and Westcott. When sold, the deeds occasionally contained restrictions to new construction in terms of setback, craftsmanship and valuation. After 1910, directories show an increase in the number of Amherst College and Massachusetts Agricultural College faculty and in the number of boarders on Lincoln joining the merchants and clergy who were formerly the dominant group. Many households had domestics, reflecting the affluent lifestyle this architecture suggests.

BIBLIOGRAPHY and/or REFERENCES

Maps 1873, 1886, 1910.

Amherst Street Lists and City Directories.

Hampshire County Registry of Deeds.

Town of Amherst Tax Records for Frank C. Sherwin, in the Jones Library, Special Collections. Thanks to Ed Wilfert for deed and tax research.

National Register of Historic Places, Registration Form, Lincoln-Sunset Historic District, Amherst, section 7, p. 13.

Pioneer Valley Planning Commission, Form B (1988), online in the MACRIS database.

INVENTORY FORM B CONTINUATION SHEET

AMHERST

160 Lincoln Avenue

MASSACHUSETTS HISTORICAL COMMISSION

Area(s) Form No.

220 Morrissey Boulevard, Boston, Massachusetts 02125

E	AMH.160
---	---------