

# FORM B – BUILDING

Assessor's Number USGS Quad Area(s) Form Number  
Assessor's Number USGS Quad Area(s) Form Number

MASSACHUSETTS HISTORICAL COMMISSION  
MASSACHUSETTS ARCHIVES BUILDING  
220 MORRISSEY BOULEVARD  
BOSTON, MASSACHUSETTS 02125

11C-64	Mt. Toby	E	AMH.
--------	----------	---	------

Photograph



**Town/City:** Amherst

**Place:** (*neighborhood or village*):  
Lincoln-Sunset National Historic District

**Address:** 234 Lincoln Avenue

**Historic Name:** Herman and Florence Page House

**Uses:** Present: Single-Family Residence

Original: Single-Family Residence

**Date:** 1927

**Source:** Newspaper article

**Style/Form:** Colonial Revival

**Architect/Builder:**

**Exterior Material:**

Foundation: not visible

Wall/Trim: wood shingle

Roof: asphalt/ composite

**Outbuildings/Secondary Structures:**

**Major Alterations** (*with dates*):

Addition 1981

**Condition:** good

**Moved:** no  yes  **Date:**

**Acreage:** .45 acre

**Setting:** On a tree-lined residential street, primarily made up of homes from the last quarter of the 19<sup>th</sup> century.

## Locus Map

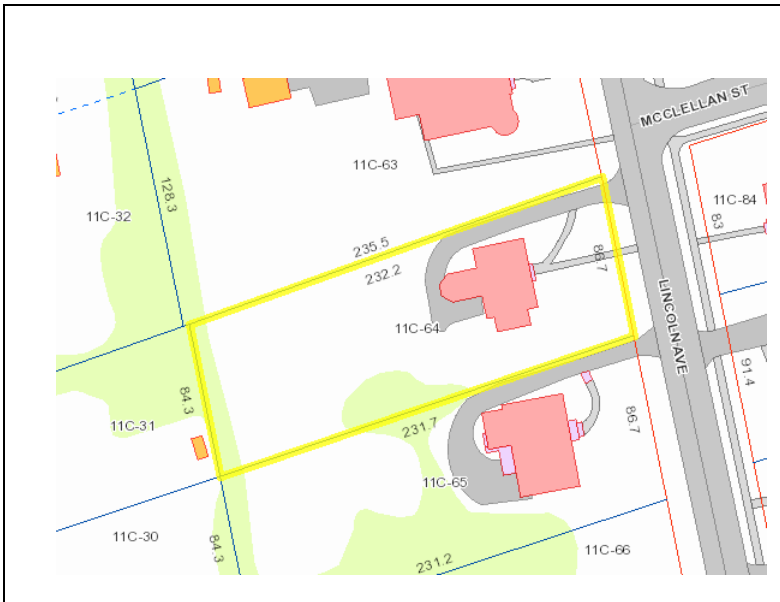

**Recorded by:** Suzannah Fabing

**Organization:** LHDSC

**Date** (*month / year*): March 2016

# INVENTORY FORM B CONTINUATION SHEET

AMHERST

234 LINCOLN AVE

MASSACHUSETTS HISTORICAL COMMISSION  
220 Morrissey Boulevard, Boston, Massachusetts 02125

Area(s) Form No.

E	
---	--

Recommended for listing in the National Register of Historic Places.  
*If checked, you must attach a completed National Register Criteria Statement form.*

*Use as much space as necessary to complete the following entries, allowing text to flow onto additional continuation sheets.*

## ARCHITECTURAL DESCRIPTION:

*Describe architectural features. Evaluate the characteristics of this building in terms of other buildings within the community.*

This two-story center-entrance Colonial has a side-gabled roof with a chimney in the south end wall. The front door, bordered by sidelights, is covered by a portico with a triangular pediment above and shallow arch at its lower edge. It stands on paired Tuscan columns. Six-over-six sash windows are employed. There is an open porch on the south side of the house. A 1981 addition at the rear is apse-like in plan.

## HISTORICAL NARRATIVE

*Discuss the history of the building. Explain its associations with local (or state) history. Include uses of the building, and the role(s) the owners/occupants played within the community.*

Herman F. and Florence E. Page built this house in 1927, one of only two private homes to be built in Amherst that year. At \$12,000, it was the more expensive of the two. The Pages remained in the house until 1974. Herman Page (1891-1975) was First Assistant Treasurer of the Amherst Savings Bank. His relationship to James Page, who lived at 160 Lincoln and was a vice-president at the same bank, is not known.

## BIBLIOGRAPHY and/or REFERENCES

Hampshire County Registry of Deeds, Book 814/157.

Town of Amherst Property Card, online at <http://www.amherstma.gov/1844/Amherst-Property-Search>.

"Building Operations Decline at Amherst. Only Two Houses Erected During Year," *Springfield Republican*, 14 January 1928. A clipping of this article is housed in the January 1928 folder in the Jones Library Special Collections.