

FORM B – BUILDING

Assessor's Number USGS Quad Area(s) Form Number

11C-134

Mt. Toby

E

AMH.

MASSACHUSETTS HISTORICAL COMMISSION
MASSACHUSETTS ARCHIVES BUILDING
220 MORRISSEY BOULEVARD
BOSTON, MASSACHUSETTS 02125

Town/City: Amherst

Place: Amherst

Photograph



Address: 38 Cosby Avenue

Historic Name: None

Uses: Present: Single-Family Residence
Original: Single-Family Residence

Date of Construction: 1920

Source: Town property form

Style/Form: Cape/Cottage

Architect/Builder:

Exterior Material:

Foundation: Unknown, likely concrete

Wall/Trim: Wood shingle

Roof: Asphalt

Outbuildings/Secondary Structures:

Major Alterations (with dates): Dormer added possibly (1987); replacement windows (1989, 2001)

Condition: Good

Moved: no yes **Date:**

Acreage: .33 acre

Setting: Rural college town.

Locus Map

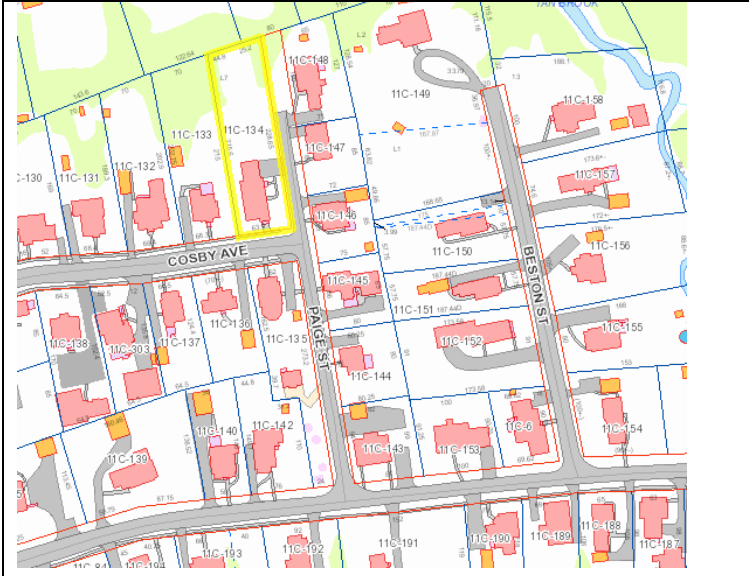

Recorded by: Elizabeth Gouin

Organization: LSHD

Date (month / year): November 2015

INVENTORY FORM B CONTINUATION SHEET

AMHERST

38 Cosby St

MASSACHUSETTS HISTORICAL COMMISSION

Area(s) Form No.

220 MORRISSEY BOULEVARD, BOSTON, MASSACHUSETTS 02125

E	
---	--

Recommended for listing in the National Register of Historic Places.

If checked, you must attach a completed National Register Criteria Statement form.

Use as much space as necessary to complete the following entries, allowing text to flow onto additional continuation sheets.

ARCHITECTURAL DESCRIPTION:

Describe architectural features. Evaluate the characteristics of this building in terms of other buildings within the community.

One-and-a-quarter-story cottage home that has been tastefully updated and renovated over the years. Front façade appears to once have a porch that was later enclosed. Four windows form a ribbon of windows on left side of the façade. Front door is oriented left. Skylights pierce the old porch's roof. One large dormer appears in center of the façade featuring two windows capped by a semi-circular arched window. A small porch supports an overhang over front door, features an interesting modified arch. 38 Cosby Avenue is similar to 27 Cosby Avenue in that both have central dormers with cornices that widen at their bases.

HISTORICAL NARRATIVE

Discuss the history of the building. Explain its associations with local (or state) history. Include uses of the building, and the role(s) the owners/occupants played within the community.

Ephraim Cosby was responsible for the relatively late development of Cosby Avenue within the Paige Street area. Beginning in 1929, Cosby acquired a lot that previously had been part of the Thomas Haley property. By this time, this holding had been subdivided and the lots, which fronted onto Lincoln Avenue, were sold off. The Cosby lot was behind the Lincoln Avenue lots and bordered by the west side of Paige Street. The Cosby Avenue subdivision was planned in 1928 with a short connector road running from Lincoln Avenue to Paige Street, with long narrow lots running perpendicular to the development's spine-Cosby Avenue. Like the later development of Fearing Street, these houses were suburban in concept and featured Colonial Revival, Tudor Revival, and Dutch Colonial style homes. These were attractively designed, quality constructed, smaller 1-1 ½-story Cape-like houses with associated garages. Several of these homes were built by Cosby as income properties and were often rented to academics into the 1940s.

The ownership from 1971-2001 was a series of University of Massachusetts faculty.

BIBLIOGRAPHY and/or REFERENCES